



# PARC HOWARD - Concept Plan



Improve links and signage to the National Cycle Network



Create woodland adventure and learning area  
Relocate multi use games court



Restore the formal paths and create a wildflower meadow and study area

Implement management programme to remove/treat invasive species

Create woodland school and study area



Create woodland habitat trail

Reintroduce putting green

Replace and install new bird, bat and bug boxes

Upgrade existing park furniture to include seating, recycling bins, dog fouling bins, cycle racks and bollards.



Relocate the car park to the west of park. Improve access and pedestrian links towards the main facilities

Repair and rebuild stone wall



Upgrade children's play area providing more facilities for children of all ages and abilities  
Introduce a 'Splash Pad' to replace the paddling pool

Renovate the Bandstand and create an amphitheatre

Restore the Rose and Memorial Garden

Enhance the formal gardens, reintroduce sun dial and fountain

Introduce disabled parking bay

Refurbish and upgrade the duck pond area and landscape

Restore gates, gate piers and railings

Activities and events promoting health and well-being, community engagement, arts and craft, horticulture and education



Create a fitness trail and outdoor gym

New shrub and tree planting

Renovate existing paths

Improve drainage to the playing field

Provide safe bike storage

Create picnic area

Explore opportunities for creating a coach drop-off bay along Felinfoel Road

Illuminate key routes through the park

Implement an external CCTV system

Introduce new signage and interpretation including park maps, finger posts, way markers for heritage trails, interpretation boards, tagging of trees and shrubs, community notice boards

The area around the mansion building could be enhanced to provide a wider range of facilities such as:

- Community Walled Garden**  
 The formal garden to the rear of the mansion could be restored and run by volunteers and horticultural trainees as a community kitchen and training garden. It could include areas for growing plants and vegetables and storing equipment, tools and materials.
- New Community Building**  
 The remnants of the existing stable block structure could be reused to provide a new facility which could house a café, new toilet facilities, soft play area and new training and education centre. This building could be run by the community and be linked with Coleg Sir Gâr. The facilities could open out onto the formal play area and onto the walled garden, with an outdoor seating terrace and shelter.
- Mansion Building**  
 The Museum and Art Gallery could be improved under a separate grant scheme. The interior of the building could be redecorated and upgraded to create a more exciting visitor attraction, with more interactive exhibits, display cases, boards and improved lighting. External building improvements could be made to the roof, portico and lantern. Opportunities could be explored to make the ground floor space in the mansion building more flexible. This could allow space to be used for social enterprise and to be hired for managed events such as meetings, weddings, community events, tea dances etc. The former cafe area and store rooms could be refurbished to create flexible studio space for pottery, photography, painting etc.

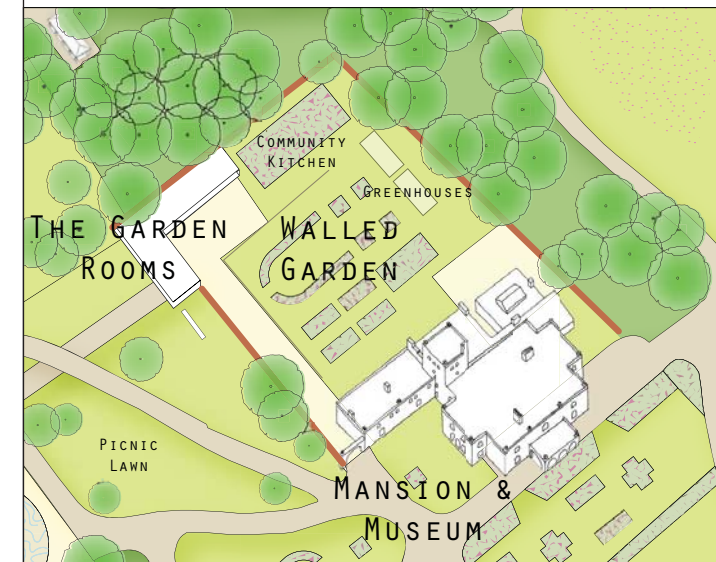



# PARC HOWARD - Concept Plan



Improve links and signage to the National Cycle Network



Create woodland adventure and learning area



Restore the formal paths and create a wildflower meadow and study area

Implement management programme to remove/treat invasive species

Create woodland school and study area



Create woodland habitat trail

Reintroduce putting green

Replace and install new bird, bat and bug boxes

Upgrade existing park furniture to include seating, recycling bins, dog fouling bins, cycle racks and bollards.



Repair and rebuild stone wall

Resurface tennis courts



Upgrade children's play area providing more facilities for children of all ages and abilities

Introduce a 'Splash Pad' to replace the paddling pool

Renovate the Bandstand and create an amphitheatre

Restore the Rose and Memorial Garden

Enhance the formal gardens, reintroduce sun dial and fountain

Create a sensory garden

Refurbish and upgrade the duck pond area and landscape

Restore gates, gate piers and railings

Activities and events promoting health and well-being, community engagement, arts and craft, horticulture and education



Create a fitness trail and outdoor gym

New shrub and tree planting

Renovate existing paths

Improve drainage to the playing field

Provide safe bike storage

Create picnic area

Explore opportunities for creating a coach drop-off bay along Felinfoel Road

Illuminate key routes through the park

Implement an external CCTV system

Introduce new signage and interpretation including park maps, finger posts, way markers for heritage trails, interpretation boards, tagging of trees and shrubs, community notice boards

The area around the mansion building could be enhanced to provide a wider range of facilities such as:

**Community Walled Garden**

The formal garden to the rear of the mansion could be restored and run by volunteers and horticultural trainees as a community kitchen and training garden. It could include areas for growing plants and vegetables and storing equipment, tools and materials.

**New Community Building**

The remnants of the existing stable block structure could be reused to provide a new facility which could house a café, new toilet facilities, soft play area and new training and education centre. This building could be run by the community and be linked with Coleg Sir Gâr. The facilities could open out onto the formal play area and onto the walled garden, with an outdoor seating terrace and shelter.

**Mansion Building**

The Museum and Art Gallery could be improved under a separate grant scheme. The interior of the building could be redecorated and upgraded to create a more exciting visitor attraction, with more interactive exhibits, display cases, boards and improved lighting. External building improvements could be made to the roof, portico and lantern. Opportunities could be explored to make the ground floor space in the mansion building more flexible. This could allow space to be used for social enterprise and to be hired for managed events such as meetings, weddings, community events, tea dances etc. The former cafe area and store rooms could be refurbished to create flexible studio space for pottery, photography, painting etc.

